



CANTILEVER WALL SYSTEM



EFCO'S CANTILEVER WALL SYSTEM (CWS)

EFCO's new Cantilever Wall System (CWS) was recently added to the lineup of standard products offered for lease. The design development capitalized on EFCO's past experience in dam construction where one-sided wall pours are required. The large 10 ft (3 m) high slab pour on the project in the picture above presented the perfect opportunity to utilize a tieless, one-sided wall form system.

EFCO'S 50K CAPACITY ANCHOR®

EFCO's new CWS incorporates a new reusable Unicorn Anchor® that secures the system to the wall and eliminates the cost of anchors normally "lost" when cast in the concrete. The EFCO Unicorn Anchor is installed by attaching it to the formwork prior to the first pour and each following pour. Once cast in the concrete, an anchor stud is attached to the internal threads of the Unicorn Anchor. The hanger beam portion of the jump frame with form roll-back is lowered on to the anchor stud and secured in place with a 1 1/4" (32 mm) Unicorn Bolt and plate assembly.

CYCLING THE SYSTEM

The CWS is quickly and easily cycled to the next level:

1. Roll the formwork back using the system's integrated rollback system.
2. Install another set of anchor studs in the Unicorn Anchor cast in the wall.
3. Remove the anchor bolt and plate assembly from the frame below.
4. Lift the frame and formwork together and lower it onto the anchor studs at the next level.

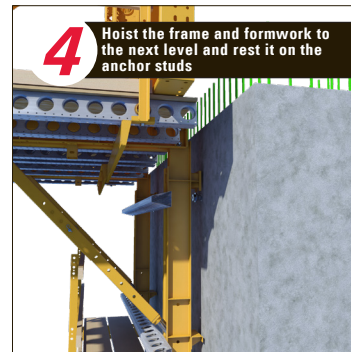
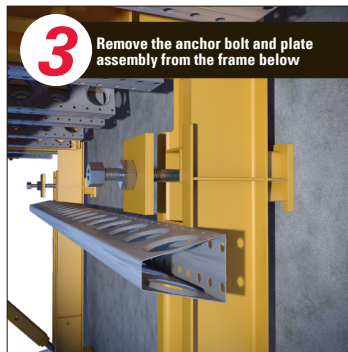
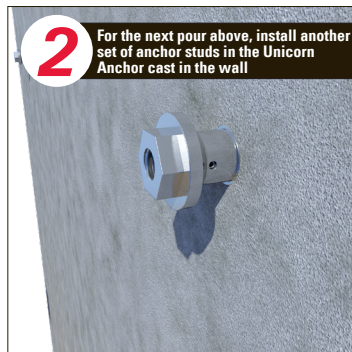
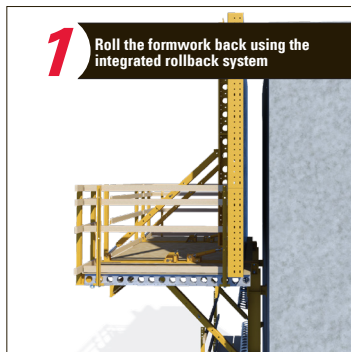

CWS is an ideal **SOLUTION** for:

dam construction, one-sided walls, shafts and multiple lift walls and mass concrete projects!

ROBUST - PRODUCTIVE - SAFE

Once in place at the next level, the formwork is ready for cleaning, oiling and final preparations for the next pour. The **Unicorn Anchor** that was previously holding the formwork in place below can now be removed and used again in pours higher up the structure. The CWS system comes with a **Unicorn Anchor Removal Tool** and wrench to simplify anchor removal. After removal the anchor is re-greased and installed on the formwork for casting into the next level.

TILT FORWARD & BACKWARD

Not all one-sided forming applications cycle vertically. EFCO's new system can handle the forming requirements of structures that have walls that tilt forward and backward. The jack head on the rollback where the form is attached has the ability to tilt the formwork forward up to a maximum of 45° and backwards up to 15°.

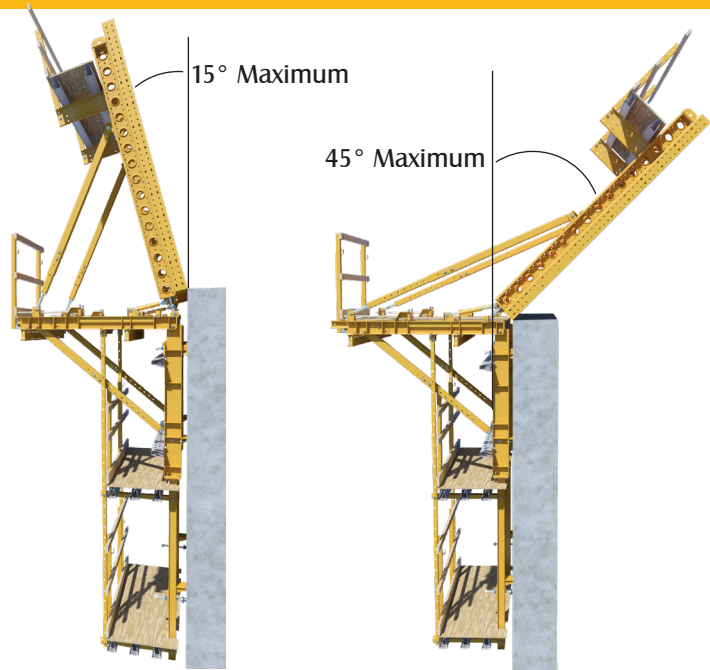

UNICORN ANCHOR INSTALLATION & CYCLING

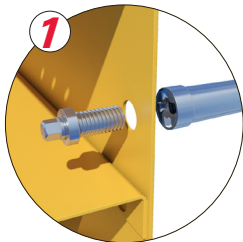
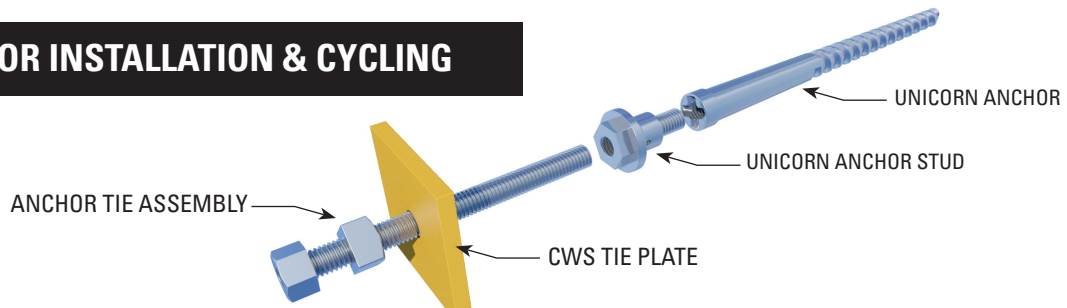

STEP 1 - Attach EFCO's re-useable Unicorn Anchor to the formwork with the Setting Bolt at locations specified in EFCO's form erection drawings.

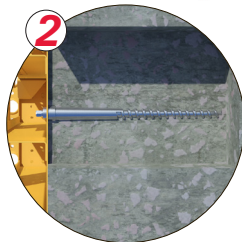

STEP 2 - Pour concrete to cast the re-useable Unicorn Anchor in structure.

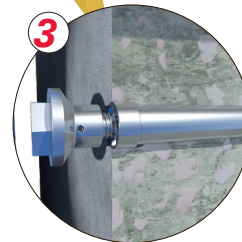

STEP 3 - Remove anchor setting bolt, roll back formwork and install Anchor Stud into Unicorn re-useable Anchor.

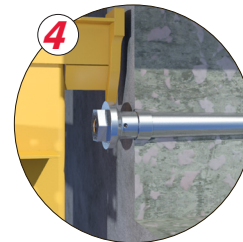

STEP 4 - Jump CWS frame from previous pour onto installed Anchor Studs.



STEP 5 - Secure CWS frame to Anchor Stud and wall with Anchor Tie and CWS Tie Plate.

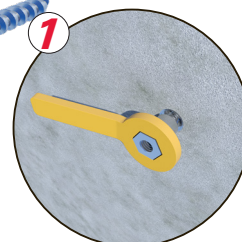
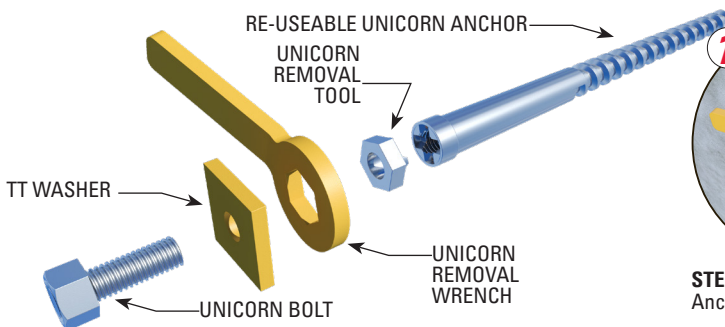

STEP 1 - Remove Unicorn Anchor Stud.

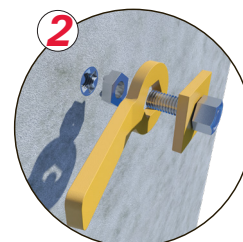

STEP 2 - Insert Unicorn Removal Tool into Unicorn Anchor.

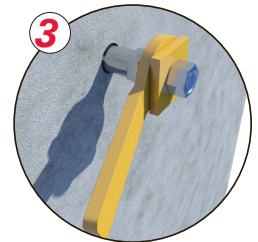

STEP 3 - Secure Removal Tool and Wrench with Unicorn Bolt. Rotate Wrench counter-clockwise to remove Unicorn Anchor from concrete.